

ST. LOUIS COUNTY PLANNING COMMISSION
MONDAY August 10, 2009 – 7:00 P.M.
41 S. CENTRAL, CLAYTON, MO 63105
COUNTY COUNCIL CHAMBERS

PET. NO.	PETITIONER	REQUEST	APPROXIMATE LOCATION	COUNCIL DISTRICT	SCHOOL DISTRICT	NO. OF ACRES
22-09	North County Development, L.L.C..	M-3 and FPM-3 to C-8 and FPC-8	East side of Riverview Drive approximately 2500 feet north of Prigge Road and extending eastward to the Mississippi River.	4	Hazelwood	376.8

*The Public Hearing Notice may be viewed on the Internet at:
<http://www.stlouisco.com>
or you may send comments via E-Mail to the Planning Commission c/o Gail Choate at:
gchoate@stlouisco.com*

IF YOU WISH TO ATTEND THIS PUBLIC MEETING AND REQUIRE ACCOMMODATION DUE TO DISABILITY, PLEASE CONTACT THE DEPARTMENT OF PLANNING 24 HOURS IN ADVANCE AT (314) 615-2520 OR (314) 615-5467 (TTY - for the hearing impaired).

St. Louis County Planning Commission will hold a public hearing at 7:00 P.M. on Monday AUGUST 10, 2009 in the County Council Chambers, Administration Building, County Government Center, 41 South Central Avenue, Clayton, Missouri 63105. If you wish to attend this public meeting and require accommodation due to disability, please contact the Department of Planning 48 hours in advance at (314) 615-2520 or (314) 615-5467 (TTY - for the hearing impaired). **The Public Hearing Notice may be viewed on the Internet at: <http://www.stlouisco.com> or you may send comments via E-Mail to the Planning Commission c/o Gail Choate at gchoate@stlouisco.com** The Planning Commission may recommend and the County Council may enact by ordinance a zoning district other than that requested in the petition, provided that the recommendation or ordinance is for a district classification of the same use type as that requested by the petition. The following request will be considered at that time:

P.C. 22-09 NORTH COUNTY DEVELOPMENT, L.L.C., c/o Edward J. Griesedieck, Herzog Crebs, L.L.P., 515 N. 6th Street, Suite 2400, St. Louis, Missouri 63101 – a request for a change in zoning from M-3 Planned Industrial District and FPM-3 Flood Plain Planned Industrial District to C-8 Planned Commercial District and FPC-8 Flood Plain Planned Commercial District for a 376.8 acre tract of land located on the east side of Riverview Drive approximately 2500 feet north of Prigge Road and extending eastward to the Mississippi River. **Proposed use: Casino, hotel, and recreational, entertainment and retail facilities, including but not limited to golf course, convention center, restaurants, surface and structural parking, and other associated uses.**

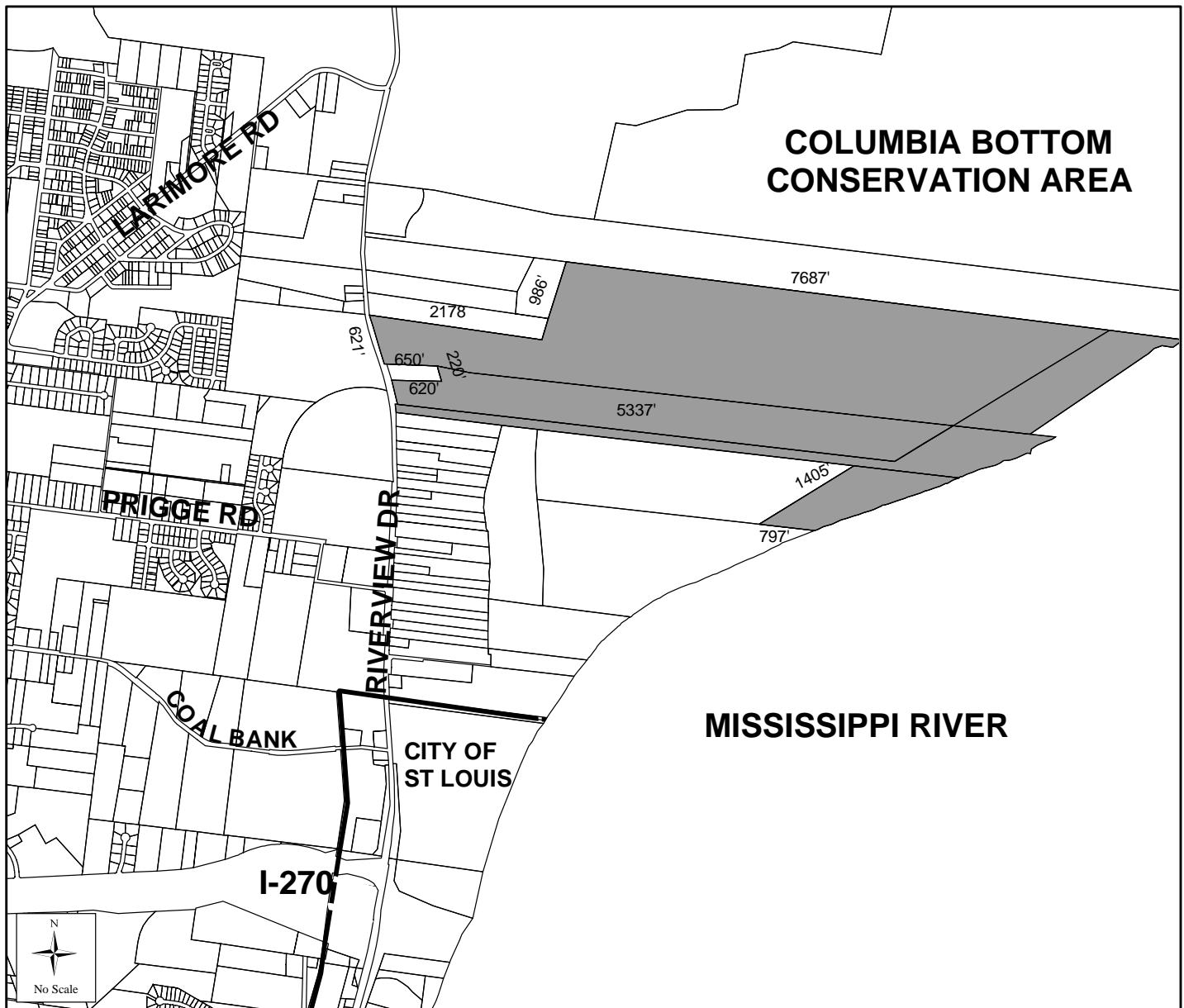

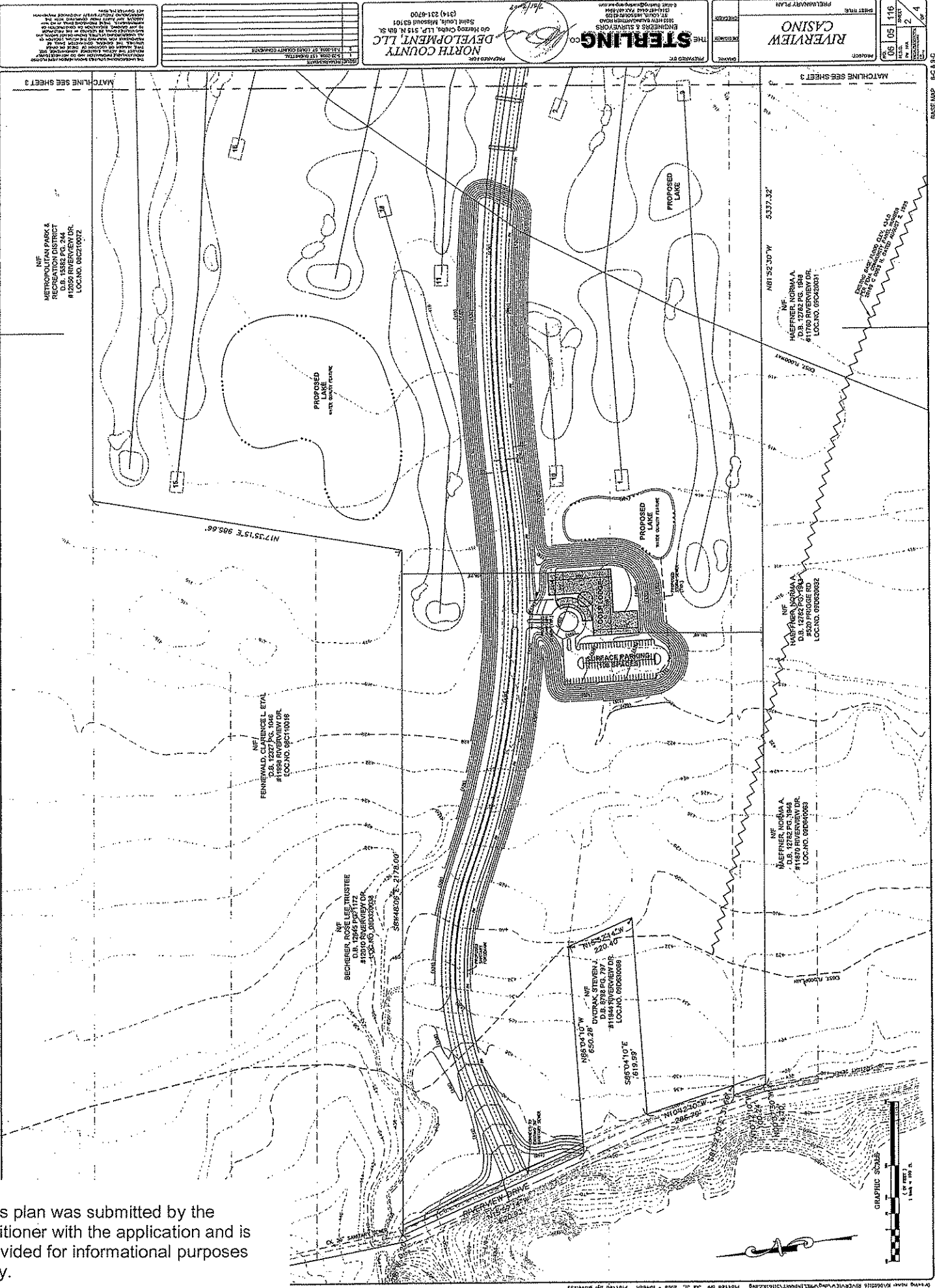

THE STERLING CO.
 ENGINEERS & SURVEYORS
 5537 RIVERVIEW DRIVE
 STATE COLLEGE, NC 27574
 (314) 231-6700
 DEPARTMENT, LLC
 OF HINGO COUNTY, LLP, 315 N. 8th St.
 State College, Missouri 63301

PROJECT: RIVERVIEW CASINO
 SHEET NO.: 116
 DATE: 05/11/16
 SCALE: AS SHOWN
 SHEET 3 OF 4

METRO PARKS &
 RECREATION DISTRICT
 D.B. 1532 P.G. 244
 #2399 RIVERVIEW DR.
 LOC. NO. 06210127

FENNEWALD, CLARENCE L. ET AL
 D.B. 1227 P.G. 1046
 #11994 RIVERVIEW DR.
 LOC. NO. 06110016

BECHERER, ROSELEE TRUSTEE
 D.B. 1265 P.G. 117
 #12010 RIVERVIEW DR.
 LOC. NO. 06210127

DIVORAK, STEVEN J.
 D.B. 2738 P.G. 797
 #1184 RIVERVIEW DR.
 LOC. NO. 06210127

HAEFFNER, NORMA A.
 D.B. 1275 P.G. 1044
 #11870 RIVERVIEW DR.
 LOC. NO. 06210127

HAEFFNER, NORMA A.
 D.B. 12782 P.G. 1044
 #11760 RIVERVIEW DR.
 LOC. NO. 06210127

HAEFFNER, NORMA A.
 D.B. 12782 P.G. 1044
 #11760 RIVERVIEW DR.
 LOC. NO. 06210127

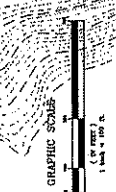

This plan was submitted by the petitioner with the application and is provided for informational purposes only.

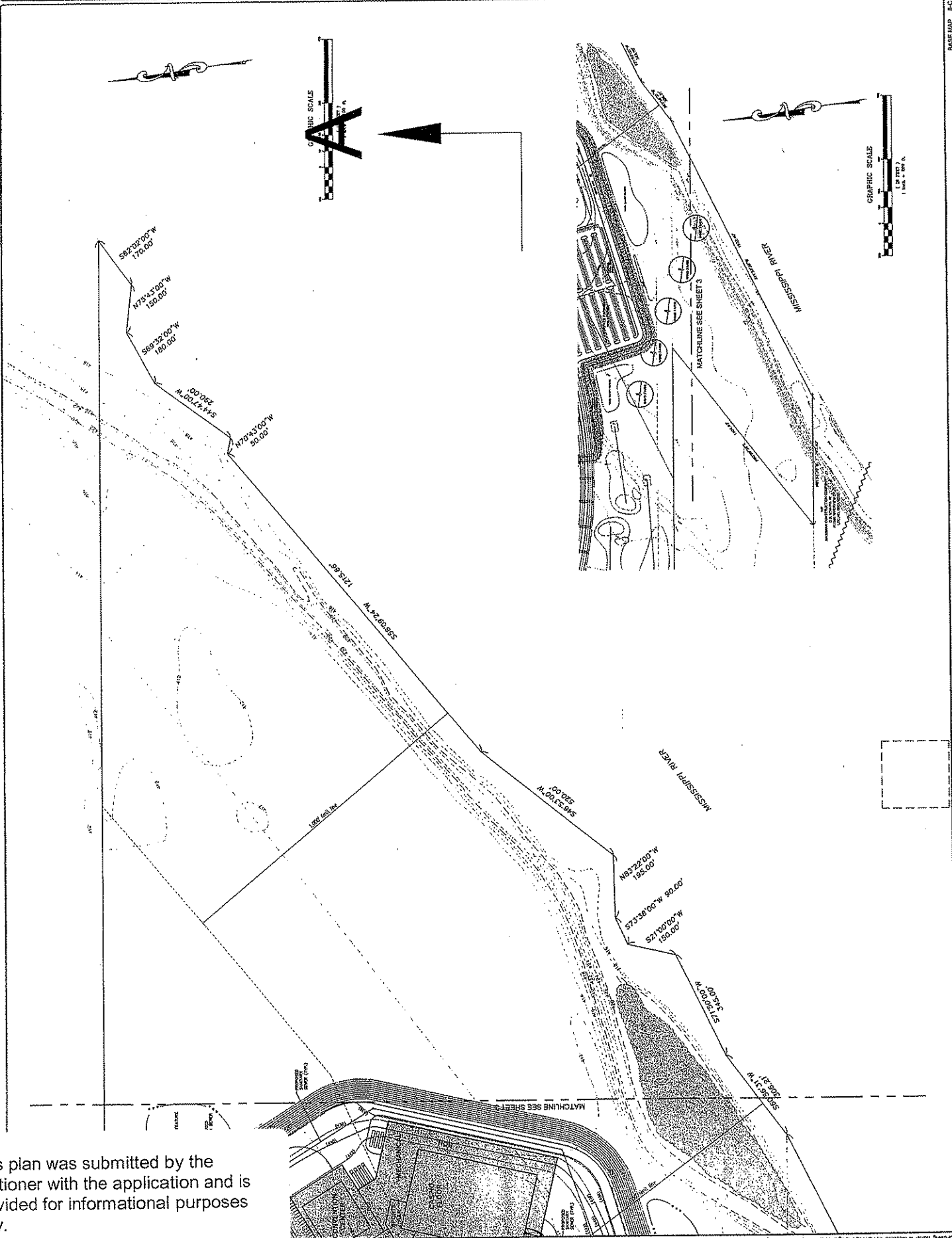

This plan was submitted by the petitioner with the application and is provided for informational purposes only.

Files and plans are available for inspection at the office of the St. Louis County Department of Planning, Fifth Floor, County Government Administration Building, 41 South Central Avenue, Clayton, Missouri 63105, during the following hours:

Monday through Friday 8:00 a.m. - 5:00 p.m.
Telephone: (314) 615-2520

ST. LOUIS COUNTY PLANNING COMMISSION

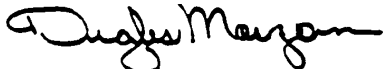

Douglas D. Morgan, Chairman

ATTEST:

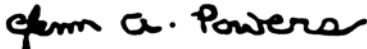

Glenn A. Powers
Director of Planning